



THE SOLUTION FOR CHANGING LIQUIDS
efficiently, clean and safe

Femco® Draintechnology system enables efficient, clean and safe way to change hot liquids like engine, gearbox and hydraulic oils and coolant.

The drain systems of Femco® guarantees that no liquids are spilled during the process and are very easy to operate. The Femco® drain plug, made of solid brass, is permanently installed in the liquid reservoir. When it's time to drain the liquid, remove the dustcover, attach the Femco® drain connector, the valve opens and the liquid flows straight to the container.

Using their large experience, Femco® has developed a standard drain system and four specific systems, each of them focused on several applications.

- **The Standard oil drain plug** works on a wide range of applications.
- **The Compact oil drain plug** is the plug with the lowest profile Femco® produce, this is the perfect choice when space is restricted. For example vehicles with a low ground clearance.
- **The Click oil drain plug** is the most effective solution for maintenance, and is particularly popular among fleet owners.
- **The Quick oil drain plug** is a two-in-one solution that combines a plug with a drain connector and is particularly suitable for fixed machinery.
- **The XL oil drain plug** has an optimised flow and is specially developed to drain large volumes in a short time.
- **The XL click oil drain plug** is a quick-coupling system which is designed to drain large volumes of oil in a short time. Flow increase of 50%!

With all these plugs the application possibilities are unlimited, the drain systems of Femco® are used in a wide variety of industries and businesses, like vehicles, earth moving machinery, transport, industry, energy, agriculture and shipping. With a product range covering over 500 thread types and sizes, Femco® can quickly respond to customers' requirements. Besides easy, clean and quick use, the drain systems of Femco® offer many other interesting advantages to their users:

- The user automatically contributes to a sustainable environment. The product can therefore be part of a company's CSR policy.
- The plug is permanently installed so problems like broken drain plugs or stripped threads are avoided.
- Less liquids are consumed and clothes, hands, floors, etc. don't have to be cleaned as often. The working environment will improve.
- The liquids can be drained without a risk of sand or soil entering the machine. This helps extend the life of the equipment.

Telephone Order Line - 01274 531531

email : sales@partline.co.uk

Fax Order Line : 01274 531088

www.partline.co.uk

STANDARD OIL DRAIN PLUG

In 1983 Femco® introduced the Standard plug to make routine oil changes a quick, clean and more environmentally friendly job.

The Standard plug is manufactured out of 100% brass, which makes it easy to change hot oil.

Additionally, the oil drain plug features a dust cover and a double O-ring, which protects the plug and ensures reliable performance.

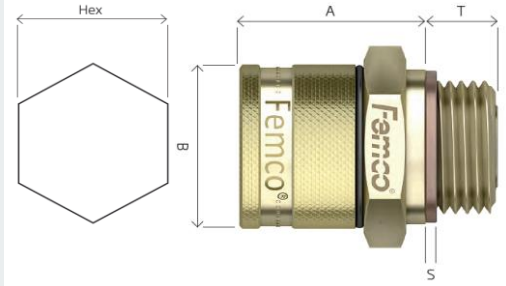

HOW TO DRAIN YOUR OIL (OR OTHER FLUIDS)

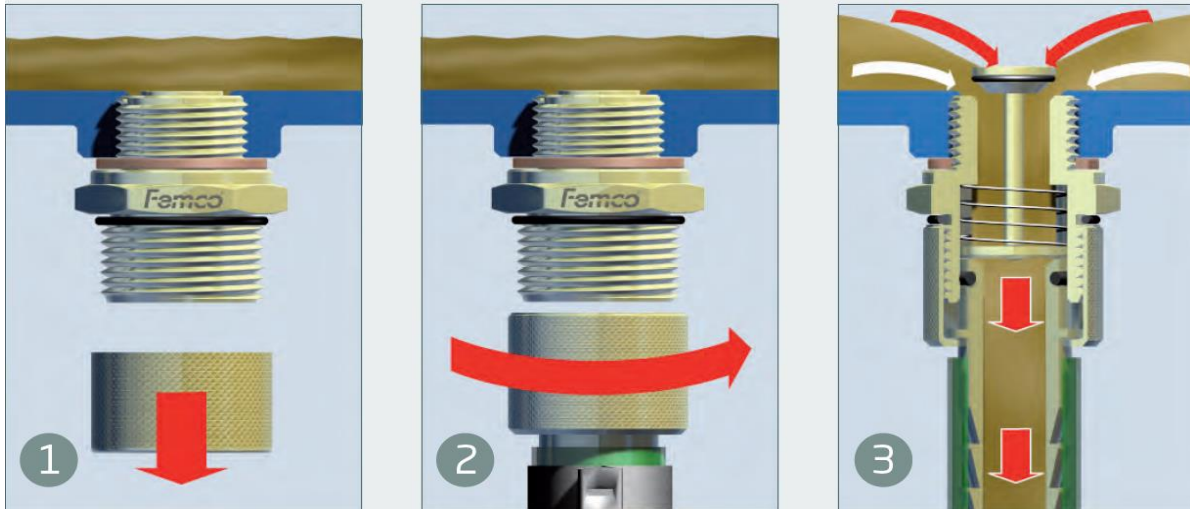

DRAIN PLUGS STANDARD							
PL REF	SIZE	LARGE / SMALL	T	A	B	S	HEX
560014	1/2" - 14 BSP	LARGE	10	32	30	2	30
560009	1/2" - 20 UNF	SMALL	10	27	25	2	22
560008	9/16" - 18 UNF	SMALL	9	27	25	2	22
560002	3/4" - 14 BSP	LARGE	10	32	30	2	32
560007	3/4" - 14 NPT	LARGE	15	27	30	N/A	32
560011	1" - 11 BSP	LARGE	12	30	30	2	36
560004	1" - 18 UNS	LARGE	12	30	30	2	36
560013	1" 1/16 - 12 UNF	LARGE	15	30	30	2	32
560015	1" 1/8 - 12 UNF	LARGE	15	27	30	2	36
560016	1" 5/16 - 12 UNF	LARGE	12	32	30	2	36
560006	M16 X 1.5	SMALL	9	27	25	2	22
560010	M18 X 1.5	SMALL	12	27	25	2	24
560003	M22 X 1.5	LARGE	10	32	30	2	30
560000	M24 X 1.5	LARGE	12	30	30	2	30
560005	M24 X 2.0	LARGE	12	30	30	2	30
560001	M26 X 1.5	LARGE	10	32	30	2	32
560012	M30 X 1.5	LARGE	10	32	30	2	36

DRAIN TUBE	DUST CAP
PL REF	PL REF
560103	560122
560100	560123
560100	560123
560103	560122
560103	560122
560103	560122
560103	560122
560103	560122
560103	560122
560103	560122
560100	560123
560100	560123
560103	560122
560103	560122
560103	560122
560103	560122
560103	560122

DRAIN TUBES						
PL REF	SIZE	LARGE / SMALL	A	B	C	D
560100	250MM	SMALL	25	17	22	15
560103	250MM	LARGE	30	20	28	19



DUST CAPS	
PL REF	PL REF
560123	SMALL
560122	LARGE